



Non-metallic Gaskets

FLAT RING GASKET DIMENSIONS TO ASME B16.21 USED WITH ASME/ANSI B16.5 RAISED FACE FLANGES

NOMINAL SIZE		ID	OD				
DN mm	NPS in.		150 lbs	300 lbs	400 lbs	600 lbs	900 lbs
15	½	21	48	54	54	54	64
20	¾	27	57	67	67	67	70
25	1	33	67	73	73	73	79
32	1¼	42	76	83	83	83	89
40	1½	48	86	95	95	95	98
50	2	60	105	111	111	111	143
65	2½	73	124	130	130	130	165
80	3	89	137	149	149	149	168
90	3½	102	162	165	162	162	-
100	4	114	175	181	178	194	206
125	5	141	197	216	213	241	248
150	6	168	222	251	248	267	289
200	8	219	279	308	305	321	359
250	10	273	340	362	359	400	435
300	12	324	410	422	419	457	498
350	14	356	451	486	483	492	521
400	16	406	514	540	537	565	575
450	18	457	549	597	594	612	638
500	20	508	606	654	648	683	699
600	24	610	718	775	768	791	838

■ = For information only Dimensions in mm

FLAT RING GASKET DIMENSIONS TO ASME B16.21 USED WITH ASME B16.47 SERIES-A RAISED FACE FLANGES

NOMINAL SIZE		ID	OD			
DN mm	NPS in.		150 lbs	300 lbs	400 lbs	600 lbs
550	22	559	660	705	702	733
650	26	660	775	835	832	867
700	28	711	832	899	892	914
750	30	762	883	953	946	972
800	32	813	940	1006	1003	1022
850	34	864	991	1057	1054	1073
900	36	914	1048	1118	1118	1130
950	38	965	1111	1054	1073	1105
1000	40	1016	1162	1114	1127	1156
1050	42	1067	1219	1165	1178	1219
1100	44	1118	1276	1219	1232	1270
1150	46	1168	1327	1273	1289	1327
1200	48	1219	1384	1324	1346	1391
1250	50	1270	1435	1378	1403	1448
1300	52	1321	1492	1429	1454	1499
1350	54	1372	1549	1492	1518	1556
1400	56	1422	1607	1543	1568	1613
1450	58	1473	1664	1594	1619	1664
1500	60	1524	1715	1645	1683	1721

NOTE: Dimensions in mm

1) NPS 22 for reference only. Size not listed in ASME B16.47

■ = For information only

FLAT RING GASKET DIMENSIONS TO ASME B16.21 USED WITH ASME B16.47 SERIES-B RAISED FACE FLANGES

NOMINAL SIZE		ID	OD				
DN mm	NPS in.		75 lbs	150 lbs	300 lbs	400 lbs	600 lbs
650	26	660	708	725	772	746	765
700	28	711	759	776	826	800	819
750	30	762	810	827	886	857	879
800	32	813	860	881	940	911	933
850	34	864	911	935	994	962	997
900	36	914	973	987	1048	1022	1048
950	38	965	1024	1045	1099	-	-
1000	40	1016	1075	1095	1149	-	-
1050	42	1067	1126	1146	1200	-	-
1100	44	1118	1181	1197	1251	-	-
1150	46	1168	1232	1256	1318	-	-
1200	48	1219	1283	1307	1368	-	-
1250	50	1270	1334	1357	1419	-	-
1300	52	1321	1387	1408	1470	-	-
1350	54	1372	1438	1464	1530	-	-
1400	56	1422	1495	1514	1594	-	-
1450	58	1473	1546	1580	1656	-	-
1500	60	1524	1597	1630	1705	-	-

■ = For information only Dimensions in mm

Flat Ring Gasket
Used With
Raised Face
Flanges

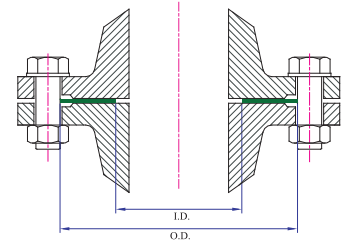

Full Face Gasket
Used With
Flat Face
Flanges

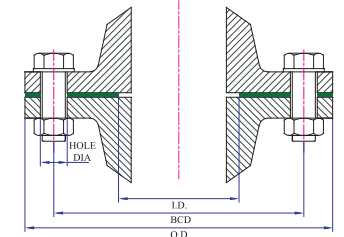

FULL FACE GASKET DIMENSIONS TO ASME B16.21 USED WITH ASME/ANSI B16.5 FLAT FACE FLANGES

NOMINAL SIZE		ID	150 lbs				* 300 lbs			
DN mm	NPS in.		OD	BCD	HOLE DIA.	No. of bolt holes	OD	BCD	HOLE DIA.	No. of bolt holes
15	½	21	89	60.3	15.9	4	95	67	16	4
20	¾	27	98	69.9	15.9	4	117	83	19	4
25	1	33	108	79.4	15.9	4	123	89	19	4
32	1¼	42	117	88.9	15.9	4	133	98	19	4
40	1½	48	127	98.4	15.9	4	155	114	22	4
50	2	60	152	120.7	19.1	4	165	127	19	8
65	2½	73	178	139.7	19.1	4	190	149	22	8
80	3	89	191	152.4	19.1	4	209	168	22	8
90	3½	102	216	177.8	19.1	8	228	184	22	8
100	4	114	229	190.5	19.1	8	254	200	22	8
125	5	141	254	215.9	22.4	8	279	235	22	8
150	6	168	279	241.3	22.4	8	317	270	22	12
200	8	219	343	298.5	22.4	8	381	330	25	12
250	10	273	406	362.0	25.4	12	444	387	29	16
300	12	324	483	431.8	25.4	12	520	451	32	16
350	14	356	533	476.3	28.6	12	584	514	32	20
400	16	406	597	539.8	28.6	16	647	572	35	20
450	18	457	635	577.9	31.8	16	711	629	35	24
500	20	508	699	635.0	31.8	20	774	686	35	24
600	24	610	813	749.3	35.1	20	914	813	41	24

■ = For information only Dimensions in mm

* AL-IMAN INTERNAL MANUFACTURING SPECIFICATIONS

FULL FACE GASKET DIMENSIONS FOR ASME B16.47 SERIES-A FLAT FACE FLANGES

NOMINAL SIZE		ID	* 150 lbs				* 300 lbs				
DN mm	NPS in.		OD	BCD	HOLE DIA.	No. of bolt holes	ID	OD	BCD	HOLE DIA.	No. of bolt holes
550	22	558.8	749	692	35	20	558.8	838	743	41	24
650	26	660.4	870	806	35	24	700	971	876	45	28
700	28	711.2	927	864	35	28	750	1035	940	45	28
750	30	762.0	984	914	35	28	805	1092	997	48	28
800	32	812.8	1060	978	42	28	860	1149	1054	51	28
850	34	863.6	1111	1029	42	32	905	1206	1105	51	28
900	36	914.4	1168	1086	42	32	955	1270	1168	54	32
950	38	965.2	1238	1149	42	32	965	1168	1092	41	32
1000	40	1016.0	1289	1200	42	36	1015	1238	1156	45	32
1050	42	1066.8	1346	1257	42	36	1065	1289	1207	45	32
1100	44	1117.6	1403	1315	42	40	1120	1352	1264	48	32
1150	46	1168.4	1454	1365	42	40	1170	1416	1321	51	28
1200	48	1219.2	1511	1422	42	44	1220	1466	1372	51	32
1250	50	1270.0	1568	1480	48	44	1270	1530	1429	54	32
1300	52	1320.8	1625	1537	48	44	1320	1581	1480	54	32
1350	54	1371.6	1682	1594	48	44	1370	1657	1549	60	28
1400	56	1422.4	1746	1651	48	48	1420	1708	1600	60	28
1450	58	1473.2	1803	1708	48	48	1475	1758	1651	60	32
1500	60	1524.0	1854	1759	48	52	1525	1809	1702	60	32

■ = For information only Dimensions in mm

* AL-IMAN MANUFACTURING SPECIFICATIONS